

This drawing and its subsequent revisions remain the copyright of Louw Group Pty Ltd and MAY NOT be reproduced or amended without prior written permission.

No liability will be accepted for amendments made by other persons. Use only written dimensions. All dimensions to be checked on site and any discrepancies to be reported in writing to the design team prior to working from.

ARCHITECTURAL NOTES

- All self doors, and doors in the path of travel to
- Exit one to comply with the relevant AS/NZS.
- Standards and the requirements of the BCA.
- All doorways to have a minimum unobstructed height of 2.0m (unless otherwise noted).
- Exit signs and emergency signs to comply with as
- Exit signs to be mounted as detailed in the electrical drawings or as otherwise approved by the relevant building surveyor.
- Portable fire extinguishers to comply with as 2444.
- Artificial lighting to comply with as 1680.
- Mechanical ventilation system to comply with as 1682 and as 3646.
- All wet areas to comply with BCA part F2D2 & all relevant parts of as 3740.
- All wet areas to have bottom plate fully wrapped with damp proof membrane, continue up wall frame 75mm AFL.
- All toilet and offset walls to be 45 STC sound rated.
- All timber used one to be headed for subterranean termite attack to a hazard level of H2 or better for non-exposed conditions.

ABBREVIATIONS

DP	Colorbond Wallaby Downpipe
BOL	Bollard
BT	Bucket Trap
FW	Floor Waste
SC	Steel Column
TR	Threshold Ramp
VP	Vent Pipe
FE	Fire Extinguisher
FHR	Fire Hose Reel
FB	Fire Blanket
DB	Distribution Board
MSB	Electrical Main Switchboard
WS	Wheel Stop
KE	Max 1.8 Kerb Ramp

Wall Paint PB 3000	154.5 SQ M
Wall Paint PB 1600	35.2 SQ M
Wall Paint PB 1700	20.4 SQ M
Wall Paint PB 2700	328.9 SQ M
Wall Paint PB 3200	294.7 SQ M
Wall Paint PB 4600	36.3 SQ M
Wall Paint PB 4800	150.7 SQ M
Wall Paint PB 4900	14.2 SQ M
Wall Paint PB Wet Area 600	20.9 M
Wall Paint PB Wet Area 1500	94.9 SQ M
Wall Paint PB Wet Area 2700	10.8 SQ M
Wall Paint Concrete 2700	4.6 SQ M

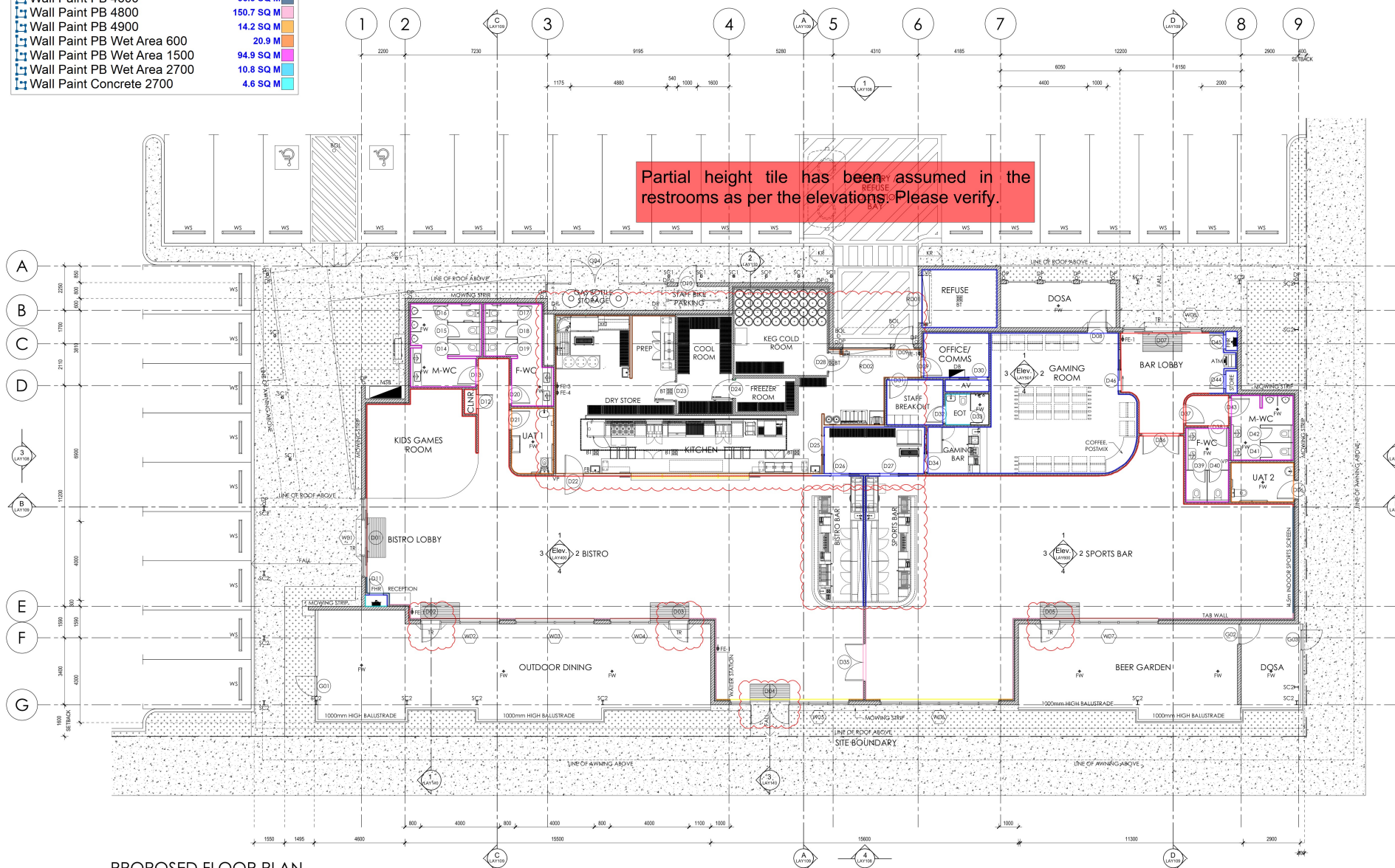

D	20/04/26	Coordinated with Marghita Bryant	KS
C	11/05/26	D38 moved towards external wall	KS
B	02/06/26	Issued for Review	KS
A	26/06/26	Internal layout adjusted to client comments	KS



prepared by:
Louw GROUP
 Tenancy 25,
 48 Marine Boulevard
 Larrakeyah, NT, 0820
 PO BOX 1034
 Darwin, NT 0801

Project: Proposed Parkside Bistro Lot 15702, Tickerton Boulevard, Duccell











Drawn by: LAY1000 Project No: 2123

Date: 11/06/26 Day: 26 Author: KS Checked: HL

Drawing Title: Proposed Floor Plan REV: D

PROPOSED FLOOR PLAN

Scale 1:100

	Paint Ceiling PB	327.0 SQ M	
	Paint Exposed Ceiling	310.7 SQ M	
	Paint Ceiling Wet Area PB	63.6 SQ M	
	Paint DropSoffit PB 500	5.4 M	
	Paint DropSoffit PB 1400	72.9 SQ M	

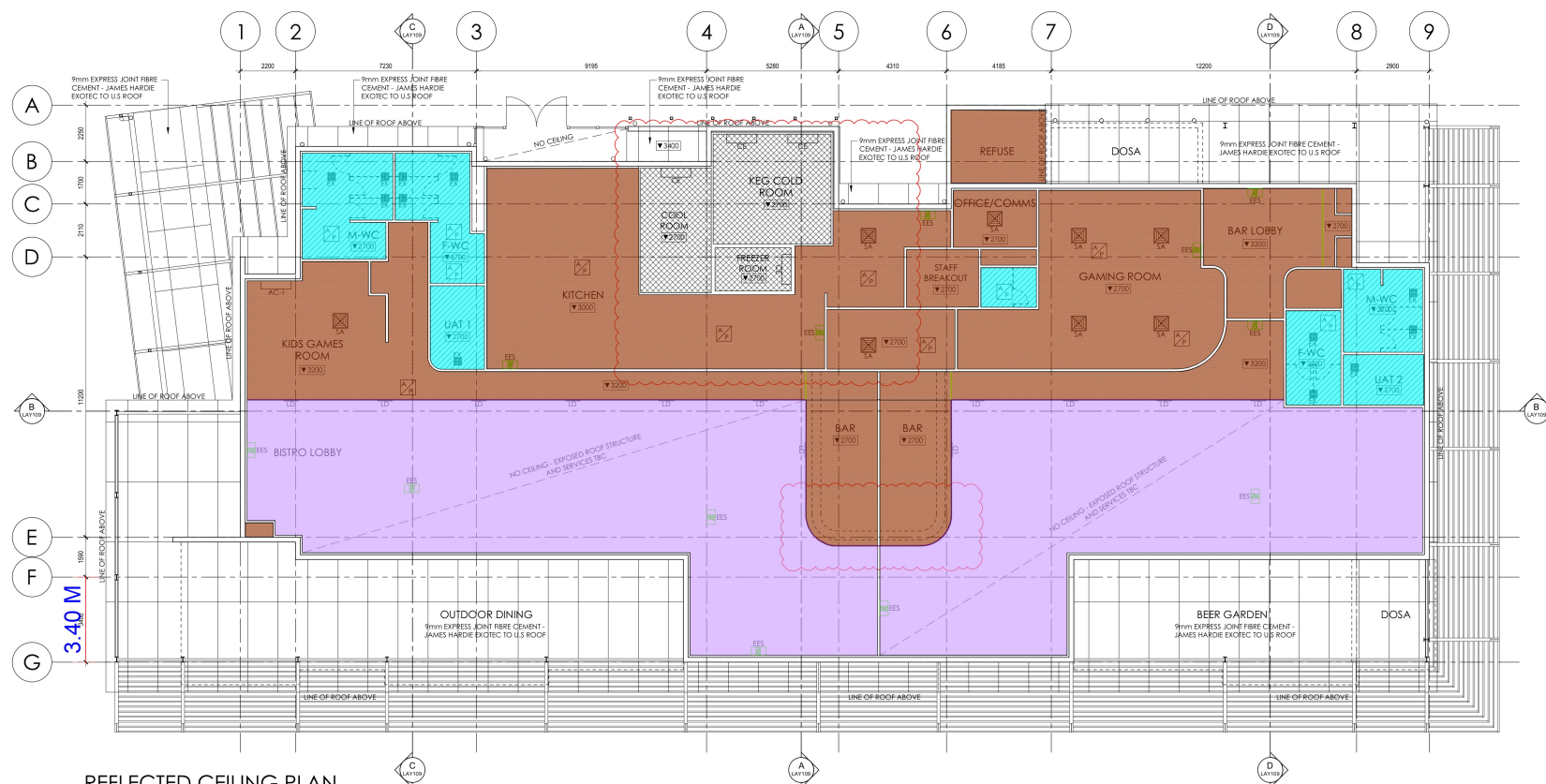

REFLECTED CEILING PLAN

Scale 1:100

Drawing Status:

PRELIMINARY

This drawing and its subsequent revisions remain the copyright of Louw Group Pty Ltd and MAY NOT be reproduced or amended without prior written permission.

No liability will be accepted for amendments made by other persons. Use only written dimensions. All dimensions to be checked on site and any discrepancies to be reported in writing to the design team prior to working from.



GENERAL NOTES

- Do not scale off this drawing.
- The contractor shall carry out a trial set-out of all ceiling and soffit types and verify with the superintendent prior to construction proceeding.
- Generally set-out rooms from centre line between walls, where no set-out shown assume central set-out.
- "Tape" relates only to opposing dimension in that dimension line.
- Check all dimensions on the within rooms prior installation of fittings, notify superintendent of any discrepancies prior proceeding.
- Ceiling heights shown are taken from the top of the floor slab.
- For mechanical and electrical equipment types and models, refer to engineers drawings.
- Set-out of all electrical and mechanical fixtures and fittings to be confirmed on site with the superintendent prior to framing, cutting etc. of the ceiling lining.
- All elements identified in AS1170.4 section 8 are to be designed, supplied & installed by the builder/contractor to ensure compliance with the requirements of AS1170.4.
- Install PS0 shadowline ceiling film to all areas u.n.c.

COLD ROOM / FREEZER NOTE:

Lighting to be supplied by refrigeration contractor. Coldroom & freezer rooms must be provided with an external indicator light that illuminates when the internal lights are switched on. Internal lighting must be controlled only by switch located adjacent to the entrance doorway within the coldroom chamber.

CEILING FINISHES LEGEND:

	Flashed plasterboard
	Wet area flushset plasterboard
	100mm thick insulated coldroom panel

ABBREVIATIONS

AC-1	AC Indoor Unit
AP	Access Panel
CE	Coldroom Evaporator
EES	Emergency Exit Signage
EA	Entrail
LD	Linear Diffuser
RA	Return Air Register
SA	Supply Air Register

B	20/04/26	Coordinated with Marjolein layout	KS
A	26/05/26	Issued for Review	KS
A	06/06/26	Issued for Review	KS



prepared by: **Louw GROUP**
 48 Marina Boulevard
 Lararakeyah, NT, 0820
 PO BOX 1034
 Darwin, NT 0801

Proposed Parkside Motors Lot 1572, Tuckeroo Boulevard, Zuccol

Drawn by: LAY009 Project No: 2123

Scale: 1:100 Date: 26 Mar 26 Author: KS Checker: HL

Drawing Title:
Reflected Ceiling Plan

REV:
B